

## **Licensing Sub-Committee**

- Section 1 - Licensing Officer's report
- Appendix 1 - Copy of the Application
- Appendix 2 - Map of the Local Area
- Appendix 3 - Representations from Responsible Authorities



## **Licensing Sub-Committee**

Section 1 - Licensing Officer's report





## LICENSING SUB-COMMITTEE

## REPORT

14 May 2012

Subject heading:

Marmaris  
181 High Street Hornchurch RM11 3XS  
Premises licence variation application  
Paul Jones, Licensing Officer  
5<sup>th</sup> floor Mercury House  
x 2692

Report author and contact details:

This application to vary a premises licence is made by Anatolian Trader Ltd under section 34 of the Licensing Act 2003. The application was received by Havering's Licensing Authority on 27<sup>th</sup> March 2012.

### Geographical description of the area and description of the building

Marmaris is a convenience store located in Hornchurch's town centre in St Andrews ward. The area is predominantly commercial; however there are residential properties in the immediate vicinity.

### Details of the application

Current premises licence hours:

<b>Supply of alcohol (off supplies)</b>		
<b>Day</b>	<b>Start</b>	<b>Finish</b>
Monday to Sunday	09:00	23:00

<b>Hours premises open to the public</b>		
<b>Day</b>	<b>Start</b>	<b>Finish</b>
Monday to Sunday	09:00	23:00

Variation applied for:

<b>Supply of alcohol (off supplies)</b>		
<b>Day</b>	<b>Start</b>	<b>Finish</b>
Monday to Thursday	08:00	00:30
Friday & Saturday	08:00	01:30
Sunday	08:00	23:00

<b>Hours premises open to the public</b>		
<b>Day</b>	<b>Start</b>	<b>Finish</b>
Monday to Thursday	08:00	00:30
Friday & Saturday	08:00	01:30
Sunday	08:00	23:00

**Comments and observations on the application**

The applicant acted in accordance with regulations 25 and 26 of *The Licensing Act 2003 (Premises licences and club premises certificates) Regulations 2005* relating to the advertising of the application. The required public notice was installed in the 6<sup>th</sup> April 2012 edition of the *Romford Recorder*.

Section P of the application requires the licence holder to detail any additional steps intended to be taken to help promote the licensing objectives as a result of the proposed variation. The licence holder proposes to extend alcohol supplies from 23:00 until 00:30 during the week and until 01:30 at the weekend; however, the applicant's entry in section P states, "We do not believe that further conditions will be necessary for this application".

St Andrews ward is subject to a saturation policy with regard to licensed premises in this ward. Licensing policy 012 in relation to applications to vary existing premises licences states:

*The LLA is committed to protecting the amenity of residents and businesses in the vicinity of licensed premises. Applications for hours set out below in this policy will generally be granted subject to not being contrary to other policies in the statement of licensing policy. Applications for hours outside the hours listed will be considered on their merits.*

*Regulated Activities will normally be permitted:*

- *until 11.30 pm in residential areas*
- *until 00.30 am in mixed use areas*
- *No limits in leisure areas.*

Paragraph 4.1 of Havering's Licensing Policy further clarifies policy 012 thus:

*This policy applies to all types of premises licences and club premises certificates. It should be noted that the operating schedules must specify both the hours in which premises are open to the customers and the hours when licensable activities are taking place. The consideration of hours of operation will be in the context of the particular circumstances of each application and the licensing objectives of preventing crime and disorder and public nuisance. The hours at which noise may occur and the disturbance of resident's rest, relaxation and sleep will be of particular concern. In general, the conditions will be framed to ensure that closing hours on nights when residents have to get up for work the next morning are earlier than when it is less likely that they will have to do so.*

**Summary**

There were no representations against this application from interested parties.

There were two representations against this application from responsible authorities, namely Havering's Noise Specialist and the Metropolitan Police.

**Details of representations**

Valid representations may only address the following licensing objectives:

- The prevention of crime and disorder
- The prevention of public nuisance
- The protection of children from harm
- Public safety

**Responsible authorities' representations**

Mr Marc Gasson, Havering's Noise Specialist, makes representation against this application based on the prevention of public nuisance licensing objective.

PC David Fern makes representation against this application on behalf of the Metropolitan Police. PC Fern contends that the applicant has not addressed the licensing objectives concerning the prevention of crime and disorder and the prevention of public nuisance.

There were no representations from any other responsible authority.

Paul Jones  
Licensing Officer  
London Borough of Havering







**Havering**  
LONDON BOROUGH

## **APPENDIX 1**

**Copy of Application**



11543



Application to vary a premises licence under the Licensing Act 2003

**PLEASE READ THE FOLLOWING INSTRUCTIONS FIRST**

Before completing this form please read the guidance notes at the end of the form. If you are completing this form by hand please write legibly in block capitals. In all cases ensure that your answers are inside the boxes and written in black ink. Use additional sheets if necessary.

You may wish to keep a copy of the completed form for your records.

I/We **ANATOLIAN TRADER LIMITED**

*(Insert name(s) of applicant)*

being the premises licence holder, apply to vary a premises licence under section 34 of the Licensing Act 2003 for the premises described in Part 1 below

<b>Premises licence number</b> 005753
------------------------------------------

**Part 1 – Premises Details**

<b>Postal address of premises or, if none, ordnance survey map reference or description</b> Marmaris Supermarket 181 High Street Hornchurch			
<b>Post town</b>	Essex	<b>Post code</b>	RM11 3XS

Telephone number at premises (if any)	
Non-domestic rateable value of premises	£19500

**Part 2 – Applicant details**

<b>Daytime contact telephone number</b>	07539 444806		
<b>E-mail address (optional)</b>			
<b>Current postal address if different from premises address</b>	ANATOLIAN TRADER LIMITED 17A THE AVENUE		
<b>Post Town</b>	London	<b>Postcode</b>	N17 6TB

**Part 3 - Variation**

Please tick yes

Do you want the proposed variation to have effect as soon as possible?

If not do you want the variation to take effect from

Day	Month	Year

**Please describe briefly the nature of the proposed variation (Please see guidance note 1)**  
Extension of hours.

If your proposed variation would mean that 5,000 or more people are expected to attend the premises at any one time, please state the number expected to attend

#### Part 4 Operating Schedule

Please complete those parts of the Operating Schedule below which would be subject to change if this application to vary is successful.

##### Provision of regulated entertainment

Please tick yes

- a) plays (if ticking yes, fill in box A)
- b) films (if ticking yes, fill in box B)
- c) indoor sporting events (if ticking yes, fill in box C)
- d) boxing or wrestling entertainment (if ticking yes, fill in box D)
- e) live music (if ticking yes, fill in box E)
- f) recorded music (if ticking yes, fill in box F)
- g) performances of dance (if ticking yes, fill in box G)
- h) anything of a similar description to that falling within (e), (f) or (g) (if ticking yes, fill in box H)

##### Provision of entertainment facilities:

- i) making music (if ticking yes, fill in box I)
- j) dancing (if ticking yes, fill in box J)
- k) entertainment of a similar description to that falling within (i) or (j) (if ticking yes, fill in box K)

##### Provision of late night refreshment (if ticking yes, fill in box L)

##### Sale by retail of alcohol (if ticking yes, fill in box M)

In all cases complete boxes N, O and P

**M**

<b>Supply of alcohol</b> Standard days and timings (please read guidance note 6)			<b>Will the supply of alcohol be for consumption (Please tick box)</b> (please read guidance note 7)	On the premises	<input type="checkbox"/>
				Off the premises	<input checked="" type="checkbox"/>
Day	Start	Finish	Both <input type="checkbox"/>		
Mon	08:00	00:30	<b>State any seasonal variations for the supply of alcohol</b> (please read guidance note 4)		
Tue	08:00	00:30			
Wed	08:00	00:30			
Thur	08:00	00:30			
Fri	08:00	01:30	<b>Non-standard timings. Where you intend to use the premises for the supply of alcohol at different times to those listed in the column on the left, please list</b> (please read guidance note 5)		
Sat	08:00	01:30			
Sun	08:00	23:00			

**N**

**Please highlight any adult entertainment or services, activities, other entertainment or matters ancillary to the use of the premises that may give rise to concern in respect of children** (please read guidance note 8)

N/A

O

<b>Hours premises are open to the public</b> Standard days and timings (please read guidance note 6)			<b>State any seasonal variations</b> (please read guidance note 4)
Day	Start	Finish	
Mon	08:00	00:30	<b>Non standard timings. Where you intend the premises to be open to the public at different times from those listed in the column on the left, please list</b> (please read guidance note 5) N/A
Tue	08:00	00:30	
Wed	08:00	00:30	
Thur	06:00	00:30	
Fri	08:00	01:30	
Sat	08:00	01:30	
Sun	08:00	23:00	

Please identify those conditions currently imposed on the licence which you believe could be removed as a consequence of the proposed variation you are seeking

None

Please tick yes

- I have enclosed the premises licence
- I have enclosed the relevant part of the premises licence

If you have not ticked one of these boxes please fill in reasons for not including the licence, or part of it, below

Reasons why I have failed to enclose the premises licence or relevant part of premises licence



**P** Describe any additional steps you intend to take to promote the four licensing objectives as a result of the proposed variation:

**a) General – all four licensing objectives (b,c,d,e)** (please read guidance note 9)

Our client is currently complying with 16 conditions, please refer to part 2 of the existing premises licence, a copy is attached for your information. We do not believe that further conditions will be necessary for this application.

**b) The prevention of crime and disorder**

**c) Public safety**

**d) The prevention of public nuisance**

**e) The protection of children from harm**

Please tick yes

- I have made or enclosed payment of the fee
- I have sent copies of this application and the plan to responsible authorities and others where applicable
- I understand that I must now advertise my application
- I have enclosed the premises licence or relevant part of it or explanation
- I understand that if I do not comply with the above requirements my application will be rejected

**IT IS AN OFFENCE, LIABLE ON CONVICTION TO A FINE UP TO LEVEL 5 ON THE STANDARD SCALE, UNDER SECTION 158 OF THE LICENSING ACT 2003 TO MAKE A FALSE STATEMENT IN OR IN CONNECTION WITH THIS APPLICATION**

**Part 5 – Signatures** (please read guidance note 10)

**Signature of applicant (the current premises licence holder) or applicant's solicitor or other duly authorised agent** (please read guidance note 11). **If signing on behalf of the applicant please state in what capacity.**

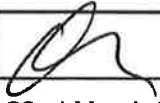
Signature	
Date	22nd March 2012
Capacity	Authorised agent

**Where the premises licence is jointly held signature of 2nd applicant (the current premises licence holder) or 2nd applicant's solicitor or other authorised agent** (please read guidance note 12). **If signing on behalf of the applicant please state in what capacity.**

Signature	
Date	
Capacity	

**Contact name (where not previously given) and address for correspondence associated with this application** (please read guidance note 13)

NARTS  
Licensing Department  
55 Stoke Newington High Street

<b>Post town</b>	London	<b>Post code</b>	N16 8EL
<b>Telephone number (if any)</b>	020 7241 3636		
<b>If you would prefer us to correspond with you by e-mail your e-mail address (optional)</b> suna.hazar@narts.gov.uk			



Premises licence number

005753

## Part 1 – Premises details

Postal address of premises

Marmaris  
181 High Street Hornchurch RM11 3XS

Where the licence is time limited the dates

Not applicable

Licensable activities authorised by the licence

Supply of alcohol

The times the licence authorises the carrying out of licensable activities

Monday to Sunday – 09:00 to 23:00

The opening hours of the premises

As above

Where the licence authorises supplies of alcohol whether these are on and/ or off supplies

Off supplies only

## Part 2

Name, (registered) address, telephone number and email (where relevant) of holder of premises licence

Anatolian Trader Ltd  
17a The Avenue London N17 6TB  
07539 444806

1 of 4

Signed ..... *COBY*  
Paul Jones, Licensing Officer

---

---

Registered number of holder

Not applicable

---

---

Name, address and telephone number of designated premises supervisor where the premises licence authorises for the supply of alcohol

Mr Murat Guler  
[REDACTED]

---

---

Personal licence number and issuing authority of personal licence held by designated premises supervisor where the premises licence authorises for the supply of alcohol

---

---

Mandatory conditions

1. No supply of alcohol may be made under the premises licence:
  - (a) at a time when there is no designated premises supervisor in respect of the premises licence, or
  - (b) at a time when the designated premises supervisor does not hold a personal licence or his personal licence is suspended.
2. Every supply of alcohol under the premises licence must be made or authorised by a person who holds a personal licence.
3. (1) The premises licence holder or club premises certificate holder shall ensure that an age verification policy applies to the premises in relation to the sale or supply of alcohol.  
(2) The policy must require individuals who appear to the responsible person to be under 18 years of age (or such older age as may be specified in the policy) to produce on request, before being served alcohol, identification bearing their photograph, date of birth and a holographic mark.

---

---

Annex 2 – Conditions consistent with the operating schedule

1. Staff shall be properly trained and utilise suitable trading procedures when providing licensable activity.
2. All alcohol displayed in the shop shall be within sight of sales staff.
3. Spirits and other high alcoholic strength products shall be displayed behind the sales counter.
4. Alcohol not on display shall be stored in a secure internal stockroom.
5. The premises shall have installed appropriate fire prevention equipment.
6. All supplies of alcohol shall be supervised by properly trained staff over 18 years of age who shall require identification to be produced by anyone appearing to be under 21 years of age.
7. All staff shall be suitably trained for their job function for the premises. The training shall be written into a programme ongoing and under constant review and must be made available to a relevant responsible authority when called upon.

8. A properly specified and fully operational CCTV system shall be installed or the existing system maintained to a satisfactory standard. The system shall incorporate a camera covering each of the entrance doors and be capable of providing an image which is regarded as 'identification standard' of all persons entering and/or leaving the premises. All other areas of risk identified in the operational requirement shall have coverage appropriate to the risk.
9. The installation or upgrading of any CCTV system shall comply with current best practice. In addition the documentation listed below shall be included in a 'system file' which should be readily available for inspection by the relevant authority:
  - site plan showing position of cameras and their field of view
  - code of practice.
  - performance specification e.g. storage capacity, image file size, IPS for each camera and purpose of each camera position
  - operational requirement
  - incident log
  - maintenance records including weekly visual checks
10. To obtain a clear head and shoulders image of every person entering the premises on the CCTV system persons entering the premises should be asked to remove headwear unless worn as part of religious observance.
11. The CCTV system shall incorporate a recording facility and all recordings shall be securely stored for a minimum of one calendar month. A system shall be in place to maintain the quality of the recorded image and a complete audit trail maintained. The system shall comply with other essential legislation and all signs as required shall be clearly displayed. The system shall be maintained and fully operational throughout the hours that the premises is open for any licensable activity. For premises using a video recording system the cassette tapes shall be used on no more than 12 occasions to maintain the quality of the recorded image.
12. The positions of all CCTV cameras shall be clearly shown on a set of plans which should form part of the 'system file'. Any alteration to the system should only be carried out after consultation with and written approval of Havering Police and the Licensing Authority.
13. Prominent clear notices shall be displayed at the point of entry to the premises and in a suitable location at any points of sale advising customers that they may be asked to produce evidence of their age.
14. All members of staff at the premises shall seek 'credible photographic proof of age evidence' from any person who appears to be under the age of 18 years and who is seeking to purchase alcohol. Such credible evidence which shall include a photograph of the customer shall include a passport, photographic driving licence or Proof of Age card carrying a 'PASS' logo.
15. All occasions when persons have been refused service shall be recorded in writing and kept at the premises for six months.
16. Prominent clear notices shall be displayed at the premises about the supply of alcohol to minors and the relevant offences involved.

---

Signed .....  
Paul Jones, Licensing Officer

---

---

**Annex 3 – Conditions attached after a hearing by the Licensing Authority**

**Not applicable**

---

---

**Annex 4 – Premises plans**

**Full premises plans are held by the Licensing Authority of the London Borough of Havering. The plans reproduced below are not to scale:**

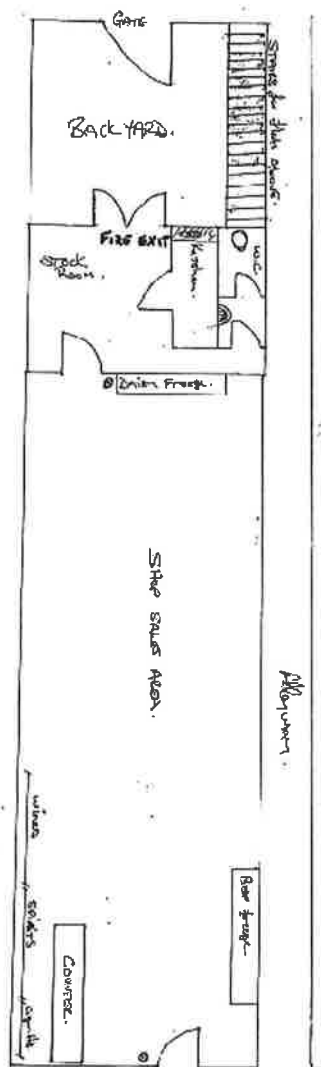



## Part B

### Premises licence summary

Premises licence number

005753

### Premises details

Postal address of premises

Marmaris  
181 High Street Hornchurch RM11 3XS

Where the licence is time limited the dates

Not applicable

Licensable activities authorised by the licence

Supply of alcohol

The times the licence authorises the carrying out of licensable activities

Monday to Sunday – 09:00 to 23:00

The opening hours of the premises

As above

Where the licence authorises supplies of alcohol whether these are on and / or off supplies

Off supplies only

Name, (registered) address of holder of premises licence

Anatolian Trader Ltd  
17a The Avenue London N17 6TB

Registered number of holder

07839997

1 of 2

Signed .....  
Paul Jones, Licensing Officer

---

---

**Name of designated premises supervisor where the premises licence authorises for the supply of alcohol**

**Mr Murat Guler**

---

---

**State whether access to the premises by children is restricted or prohibited**

**Not applicable**

**2 of 2**

---

---



# Recorder Classified

www.JUMBO24.co.uk

Telephone 0845 6714460

Property | Recruitment | Public Notices | Family Announcements | Articles for Sale | Expert Services | Motors | Personal

## PUBLIC NOTICES

To advertise call  
0208 477 3739

TO ADVERTISE IN THIS  
SECTION OF THE NEWSPAPER  
CALL OUR SALES TEAM TODAY ON  
**020 8477 3777**

## LEGAL AND PUBLIC NOTICES

### LICENSING ACT 2003 NOTICE OF APPLICATION TO VARY A PREMISES LICENCE

NOTICE IS HEREBY GIVEN that ANATOLIAN Trader LTD have applied to Havering Council to vary a premises licence in respect of the premises known as Marmaris Supermarket, 181 High Street, Hornchurch, Essex, RM11 3KS as follows:  
Supply of alcohol for consumption off the premises:  
From 08:00 to 00:30 Monday to Thursday  
From 08:00 to 01:30 Friday to Saturday  
From 08:00 to 23:00 Sunday  
Any person wishing to make representation in respect of the above activities may do so by writing to Licensing Team, 5th Floor, Mercury House, Mercury Gardens, Romford, Essex, RM1 3SL by 25th April 2012.  
A copy of the application is kept by Licensing Team, 5th Floor, Mercury House, Mercury Gardens, Romford, Essex, RM1 3SL. The application can be viewed Monday to Friday 9.00am to 5.00pm, except bank holidays.  
It is an offence knowingly or recklessly to make a false statement in connection with an application. The maximum fine for which a person is liable on summary conviction for making a false statement is a level 5 fine on the standard scale.

**NORMAN MICHAEL DEAN (Deceased)**  
Pursuant to the Trustee Act 1925 any persons having a claim against or an interest in the Estate of the aforementioned deceased, late of 11 Woodlands Avenue Romford Essex RM6 6EA, who died on 05/12/2011, are required to send particulars thereof in writing to the undersigned on or before 15/06/2012, after which date the Estate will be distributed having regard only to claims and interests of which they have had notice.  
**THE CO-OPERATIVE TRUST CORPORATION LIMITED**  
(Co Reg No 06323818)  
New Century House Manchester M60 4ES  
(Ref: GXB/1014463P/Dean)

### ALFRED WILLIAM WATSON (Deceased)

Pursuant to the Trustee Act 1925 any persons having a claim against or an interest in the Estate of the aforementioned deceased, late of 19 Crystal Avenue Hornchurch Essex RM12 6AB, who died on 29/01/2012, are required to send particulars thereof in writing to the undersigned Solicitors on or before 15/06/2012, after which date the Estate will be distributed having regard only to claims and interests of which they have had notice.  
**PINNEY TALFOUR LLP**  
Crown House 40 North Street Hornchurch Essex RM11 1EW

## LEGAL AND PUBLIC NOTICES

### LONDON BOROUGH OF HAVERING NOTICE OF APPLICATIONS FOR PLANNING PERMISSION

Notice is hereby given that the Council has received the following applications which need to be advertised for the reasons set out below:

- |                                                                                                                                                                                                                                                                                                                                                                                                                                                                                                                                                                                                                                                                                                                                                                                                                                                                                                                                                                                                                                                                                                                                                                                                                                                                                                                                                                                                                                                                                                                                                                                                                                                                                                                                                                                                                                                                                                                                                                                                                                                                        |                                                                                                                                                                                                                                                                                                                                                                                                                                                                                                                                                                                                                                                                                                                                                                                                                                                                                                                                                                                                                                                                                                                                                                                                                                                                                                                                                                                                                                                                                                                                                                                                                                                                                                                                                                                                                                                                                                                      |
|------------------------------------------------------------------------------------------------------------------------------------------------------------------------------------------------------------------------------------------------------------------------------------------------------------------------------------------------------------------------------------------------------------------------------------------------------------------------------------------------------------------------------------------------------------------------------------------------------------------------------------------------------------------------------------------------------------------------------------------------------------------------------------------------------------------------------------------------------------------------------------------------------------------------------------------------------------------------------------------------------------------------------------------------------------------------------------------------------------------------------------------------------------------------------------------------------------------------------------------------------------------------------------------------------------------------------------------------------------------------------------------------------------------------------------------------------------------------------------------------------------------------------------------------------------------------------------------------------------------------------------------------------------------------------------------------------------------------------------------------------------------------------------------------------------------------------------------------------------------------------------------------------------------------------------------------------------------------------------------------------------------------------------------------------------------------|----------------------------------------------------------------------------------------------------------------------------------------------------------------------------------------------------------------------------------------------------------------------------------------------------------------------------------------------------------------------------------------------------------------------------------------------------------------------------------------------------------------------------------------------------------------------------------------------------------------------------------------------------------------------------------------------------------------------------------------------------------------------------------------------------------------------------------------------------------------------------------------------------------------------------------------------------------------------------------------------------------------------------------------------------------------------------------------------------------------------------------------------------------------------------------------------------------------------------------------------------------------------------------------------------------------------------------------------------------------------------------------------------------------------------------------------------------------------------------------------------------------------------------------------------------------------------------------------------------------------------------------------------------------------------------------------------------------------------------------------------------------------------------------------------------------------------------------------------------------------------------------------------------------------|
| <p><b>Application:</b> L0001.12<br/><b>Location:</b> 27 St Marys Lane Upminster<br/><b>Development:</b> Listed building Consent for conversion back into two cottages with single storey rear extensions and alterations to front elevation<br/><b>Applicant:</b> Mr. C. Hulme<br/><b>Reason(s):</b> The development relates to a Listed Building</p> <p><b>Application:</b> P0239.12<br/><b>Location:</b> 4 Squirrel Heath Avenue Romford<br/><b>Development:</b> Removal of existing drive and hardstanding and laying new drive with borders and proper drainage. Adding new plants &amp; hedges<br/><b>Applicant:</b> Mr. R. Woods<br/><b>Reason(s):</b> The development is in a Conservation Area</p> <p><b>Application:</b> P0276.12<br/><b>Location:</b> 27 St Mary's Lane Upminster<br/><b>Development:</b> Conversion back into two cottages with single storey rear extensions and alterations to front elevations<br/><b>Applicant:</b> Mr C Hulme<br/><b>Reason(s):</b> The development relates to a Listed Building</p> <p><b>Application:</b> P0279.12<br/><b>Location:</b> Hazelwood 365 Front Lane Cranham Upminster<br/><b>Development:</b> Rear ground floor conservatory extension.<br/><b>Applicant:</b> Mr &amp; Mrs Duncan Alexander<br/><b>Reason(s):</b> The application is contrary to the Metropolitan Green Belt Policies of the Core Strategy and Development Control Policies Development Plan Documents.</p> <p><b>Application:</b> P0328.12<br/><b>Location:</b> 4 Meadow Romford<br/><b>Development:</b> Demolition of existing sheds, air raid shelter and garage and construction of 1 No. garden shed and 1No. summer house outbuilding in rear garden<br/><b>Applicant:</b> Mr B Felstead<br/><b>Reason(s):</b> The development is in a Conservation Area</p> <p><b>Application:</b> P0330.12<br/><b>Location:</b> 15 Balgore Square Gidea Park Romford<br/><b>Development:</b> Garage conversion to habitable room<br/><b>Applicant:</b> Mr &amp; Mrs Burgess<br/><b>Reason(s):</b> The development is in a Conservation Area</p> | <p><b>Application:</b> P0342.12<br/><b>Location:</b> Northern end of Benskins Lane Noak Hill Romford<br/><b>Development:</b> Construction of a building comprising 9 stables, and 1 storage unit, plus 2.4m fencing<br/><b>Applicant:</b> Mr K Griffiths<br/><b>Reason(s):</b> The application is contrary to the Metropolitan Green Belt Policies of the Core Strategy and Development Control Policies Development Plan Documents.</p> <p><b>Application:</b> P0346.12<br/><b>Location:</b> 19 Gidea Close Gidea Park Romford<br/><b>Development:</b> Single storey rear extension and internal alterations<br/><b>Applicant:</b> Mr S Froud<br/><b>Reason(s):</b> The development is in a Conservation Area</p> <p><b>Application:</b> P0363.12<br/><b>Location:</b> 1 Church Lane Cottages Church Lane North Ockendon Upminster<br/><b>Development:</b> Proposed 1.5m Boundary Fence<br/><b>Applicant:</b> Ms S King<br/><b>Reason(s):</b> The development is in a Conservation Area. The application is contrary to the Metropolitan Green Belt Policies of the Core Strategy and Development Control Policies Development Plan Documents</p> <p><b>Application:</b> P0372.12<br/><b>Location:</b> Manor Farm Ockendon Road<br/><b>Development:</b> Single storey rear extension to kitchen<br/><b>Applicant:</b> Mrs. J. Mea<br/><b>Reason(s):</b> The development relates to a Listed Building</p> <p><b>Application:</b> P0414.12<br/><b>Location:</b> Forest Row Centre Lodge Lane Collier Row<br/><b>Development:</b> Part change of use of existing sports hall to allow for a childcare facility. External awning to elevation, fencing (2-3m high) and external storage container<br/><b>Applicant:</b> Mr. A. Nicholls<br/><b>Reason(s):</b> The application is contrary to the Metropolitan Green Belt Policies of the Core Strategy and Development Control Policies Development Plan Documents.</p> |
|------------------------------------------------------------------------------------------------------------------------------------------------------------------------------------------------------------------------------------------------------------------------------------------------------------------------------------------------------------------------------------------------------------------------------------------------------------------------------------------------------------------------------------------------------------------------------------------------------------------------------------------------------------------------------------------------------------------------------------------------------------------------------------------------------------------------------------------------------------------------------------------------------------------------------------------------------------------------------------------------------------------------------------------------------------------------------------------------------------------------------------------------------------------------------------------------------------------------------------------------------------------------------------------------------------------------------------------------------------------------------------------------------------------------------------------------------------------------------------------------------------------------------------------------------------------------------------------------------------------------------------------------------------------------------------------------------------------------------------------------------------------------------------------------------------------------------------------------------------------------------------------------------------------------------------------------------------------------------------------------------------------------------------------------------------------------|----------------------------------------------------------------------------------------------------------------------------------------------------------------------------------------------------------------------------------------------------------------------------------------------------------------------------------------------------------------------------------------------------------------------------------------------------------------------------------------------------------------------------------------------------------------------------------------------------------------------------------------------------------------------------------------------------------------------------------------------------------------------------------------------------------------------------------------------------------------------------------------------------------------------------------------------------------------------------------------------------------------------------------------------------------------------------------------------------------------------------------------------------------------------------------------------------------------------------------------------------------------------------------------------------------------------------------------------------------------------------------------------------------------------------------------------------------------------------------------------------------------------------------------------------------------------------------------------------------------------------------------------------------------------------------------------------------------------------------------------------------------------------------------------------------------------------------------------------------------------------------------------------------------------|

Application details, including the plans, can be viewed online at [www.havering.gov.uk/planning](http://www.havering.gov.uk/planning) or at the Planning reception, located in the Public Advice and Service Centre (PASC), accessed via the Liberty Shopping Centre, Romford, between 9am and 2pm, Monday to Friday.

If you wish to comment on an application, please use the online comment form available on the council's web site or alternatively write to the Head of Development and Building Control at the 3rd Floor, Mercury House, Mercury Gardens, Romford, RM1 3SL quoting the application number and location. Comments must be received within 21 days from the date on this notice. Please note that members of the public are entitled to see and take copies of any comments you make and your comments may also be available to view on the internet.

**Patrick Keyes**  
Head of Development and Building Control

Date: 6th April 2012  
Published in Romford Recorder: 6th April 2012

TO ADVERTISE IN NEXT  
WEEKS PAPER CALL OUR  
SALES TEAM TODAY ON  
**020 8477 3777**

### LONDON BOROUGH OF HAVERING ROAD TRAFFIC REGULATION ACT 1984, SECTION 14(1)

"The London Borough of Havering (Leamington Close and Leamington Road, RM3)

#### Temporary Road Traffic Restriction No.1 Order 2012"

Notice is given that on the 6th day of April 2012 the London Borough of Havering made "The London Borough of Havering (Leamington Close and Leamington Road, RM3) Temporary Road Traffic Restriction No.1 Order 2012" ("the Order") being satisfied that the Order is necessary because of construction and infrastructure works in and around the former garage site in Leamington Close (the "Works") the effect of which will be to restrict parking in Leamington Close and Leamington Road as described in the Order and the attached Schedule.

- The Order shall come into effect on the 7th April 2012 and may be cited as "The London Borough of Havering (Leamington Close and Leamington Road, RM3) Temporary Road Traffic Restriction No.1 Order 2012"
- The prohibitions will only be operational when traffic signs indicating that such prohibitions are in operation are displayed on the street
- Nothing in the Order shall apply so as to prevent access to premises on or adjacent to the prohibited Road insofar as such access is reasonably practicable having regard to the Works, health and safety
- The Order may continue in force until Saturday 5th October 2013 at 13:00hrs or until the works are completed, whichever is the sooner
- Please contact David Ballm (01708 433750) with any query regarding the Order or to obtain copies of the Order

DATED this 6th day of April 2012  
Published in Romford Recorder: 6th April 2012

**IAN BURNS**  
Acting Assistant Chief Executive  
Town Hall, Main Road, Romford, RM1 3BD

#### SCHEDULE

LENGTHS OF ROADS and RESTRICTION	DURATION	ALTERNATIVE ROUTES
In Leamington Close and Leamington Road RM3 - No Parking, waiting or loading both sides of Leamington Close for its entire length and No Parking, waiting or loading in Leamington Road on its eastern side for a distance of 10 metres either side of its junction with Leamington Close.	Monday to Saturday 08:00 hours to 18:00 hours. From Saturday 7th April 2012 at 08:00 hours to Saturday 5th October 2013 at 13:00 hours or ending sooner upon completion of the Works.	N/A





**Havering**  
LONDON BOROUGH

Map of the area



Scale @ A4  
1:1250

Scale  
0 10 20 30 40 50 m

Map Reference: TQ5487SW  
Date: 28/03/2012

© Crown copyright and database rights 2012 Ordnance Survey 100024327

**Mamaris 181 High Street Hornchurch RM11 3XS**

London Borough of Havering  
Town Hall, Main Road  
Romford, RM1 3BD  
Tel: 01708 434343

**nlpg**  
The National  
Land & Property Gateway

**MSG**  
NATIONAL  
STREET  
DATA

**Ordnance Survey**  
Licensed Partner

**Havering**  
LONDON BOROUGH



**Haverling**  
LONDON BOROUGH

APPENDIX '3'

Representations from  
Responsible Authorities





**METROPOLITAN  
POLICE**

Working together for a safer London

**Licensing Authority  
London Borough Havering  
Mercury House, Mercury Gardens  
Romford  
RM1 3SL**

PC 118 KD David Fern  
Romford Police Station  
19 Main Road  
Romford,  
Essex  
RM1 3BJ

Telephone: 01708 432781  
Email:  
David-  
anthony.fern@met.police.uk  
Date: 20th April 2012

Police wish to make representation **against** the application to vary the premises licence at 181 High Street, Hornchurch, RM11, Marmaris Supermarket.

- The premises falls within the saturation area of ST Andrews ward and full details of the policy can be found on the London Borough of Havering website.
- Police feel that the applicant as not addressed the licensing objectives of prevention of crime and disorder along with public nuisance.
- This application if granted will have a cumulative impact in an area already under stress.

There are no additional conditions offered or any suggestion of staffing levels during these additional hours, requesting to remain open for the sale alcohol.

There are no additional security measures implied to prevent disorder, the majority of bars and licensed premises within this area close before the times requested in this application at the weekends. There are no other supermarkets open to such hours in Hornchurch.

Times requested  
Monday - Thursday 0030 hours.  
Friday and Saturday 0130 hours.  
Sunday - no change 2300 hours.

These premises are located towards the middle of the High street and therefore the potential to attract business from both directions. There is direct parking outside the location.

It is far from people strolling around Hornchurch High street doing there weekly shop at such hours. I would suggest this is an application purely profit driven with no concerns for the community or the local residents.

The premises would be magnet for the public to obtain alcohol and will no doubt add to the disorder already highlighted in the saturation policy.

This would fuel the availability of alcohol and only encourage street drinking, congregating of groups and Anti social behaviour. This in turn leads to crime and Disorder along with public nuisance.

Merely the cheery good byes or shouting in the street, shutting of cars doors, starting and revving of engines course noise, which could be deemed reasonable however the licensing authority is entitled to take this into account as it creates nuisance locally.

Street drinking often leads to criminal damage, urination, littering and general deterioration of the public realm.

- The shop would attract predominately those who have been out drinking and enjoying the night time economy, many under the influence of alcohol and drugs.
- Police have conducted drugs test in licensed establishments within the vicinity and high readings have been reported of cocaine in these premises.
- There are likely to be fights at the location which is associated with alcohol fueled customers, especially given the hours requested.
- There is limited public transport from Hornchurch at this time of night therefore members of the public will be loitering, waiting for taxi's or people to pick them up, no doubt drinking the alcohol purchased.
- This will also become an area that illegal mini cabs target. This will increase the risk of public safety at the location.

This area is at present a fairly quite street, the accumulation of individuals emerging into the street will wake neighbours. This will impact on the licensing objective prevention of Public nuisance. There are residential units located directly above and an alley way to the side which leads to the rear of shops and flats.

Police could not support this application to vary the premises hours, this would go against the licensing objectives of prevention of crime and disorder by creating a cumulative impact in an area under stress.

The impact of noise from patrons and people loitering would also impact on the prevention of public nuisance.

I ask the committee not to grant any additional hours to the premises.

Following a recent inspection at the premises on 18th April 2012, the following points were raised with the DPS due non compliance of the licence conditions.

ABNNEX 2  
Conditions



2 - This condition states that sprits and alcohol of high strength must be kept behind the counter. This was not the case and the alcohol had expanded approximately one (1) metre outside of the counter.

9 - Relates to CCTV, there was no plan available, incident log, maintenance records or weekly checks were not being carried out, or any documents created. This is vital to ensure the system is working correctly in order to prevent crime and detect offenders.

15 - Refusal log the sales assistant did not know where the log was, Mr Gojhan. He made two refusals during my time at the shop. Once the DPS arrived a log was produced showing 3 refusals only 14, 15, 18th March 2012. I suggest that this document is not being completed in accordance and find it alarming a member of staff who works there part time does not know where the log book is.

The rear fire exit to the rear of the premises was blocked by a shutter on the outside of the building; I made it clear that this needs to remain open and is serious breach of health and safety. I suggested door alarms to be fitted if the concern for security was an issue. I also suggested that the DPS liaised with a local fire officer.

The DPS/ Owner is relatively new at the premises I explained the issues of the town centre to him and why the licensing authority had saturation and cumulative impact in place.

There are failings in the way the premises are currently operating and this needs to be addressed. The DPS was unaware of the issues of the town centre and the potential for crime and disorder, particularly at such hours as requested. This makes the police feel the premises would be a vulnerable target for crime and disorder.

The police licensing officer will continue to work with the applicant and their representative in an effort to develop the business and the community.

If I can be of any further assistance in this matter please do not hesitate to contact me in the licensing office.

Yours sincerely

David Fern  
Police licensing Officer  
Havering Borough.





**Havering**  
LONDON BOROUGH

**Public Protection**  
Mercury House, Mercury Gardens  
Romford RM1 3SL

**Please call: Marc Gasson**  
**Telephone: 01708 432749**  
Fax: 01708 432554  
email: marc.gasson@havering.gov.uk  
Textphone ☎: 01708 433175

## memo

From: Marc Gasson-Noise Specialist  
To: Paul Campbell-Licensing Specialist

My Reference : MDG/076992  
Your Reference :

Date: 3 April 2012

### **Licensing Act 2003-Application To Vary Premises Licence Marmaris Supermarket, 181 High Street, Hornchurch, Essex.**

I refer to the above application and would object to any extension in the opening hours for the premises or the hours for the supply of alcohol above that that they already have. Any extension would encourage people to congregate in the vicinity increasing the likelihood of noise disturbance being caused to nearby residents.

Marc Gasson  
Noise Specialist